

**HAWAI'I
PACIFIC
HEALTH**

**HAWAI'I
HEALTH
PARTNERS**

CREATING A HEALTHIER HAWAI'I



HHP 6TH Annual Membership Meeting

09 | 28 | 19

9 AM — 4 PM | SATURDAY

Hilton Hawaiian Village
Waikiki Beach Resort • Coral Ballroom

WELCOME PACKET

TABLE OF CONTENTS

Welcome Note	3
HHP-At-A-Glance	4
Schedule-At-A-Glance	5
Session Descriptions.....	8
Session Objectives.....	9
Important Reminders.....	10
Speakers & Presenters	12
Opening Ceremonies.....	12
State of the ACO	12
Strength of Hospital Partnerships in Enhancing Patient Care Options	13
Joy in Practice and Redefining Patient Care	15
Improving Patient Access and Specialty Care with eConsults	16
Pediatrics Breakout Session: Subspecialty Access and Referral Processes	17
Obstetrics & Gynecology Breakout Session: How HHP Membership Can Make Your Life Better as an OB/GYN	18
Clinical Workgroup Presentations	19
CME/MOC	20
Special Events	21
Meeting Map	22
Acknowledgements	23

WELCOME

Dear Colleagues:

It is our great pleasure to welcome you to the Hawai'i Health Partners (HHP) 6th Annual Membership Meeting.

Our inaugural membership meeting was held in 2014, the year of our founding. It was then that we shared with you the vision of transforming health care in Hawai'i and introduced the role of a new patient care model, an Accountable Care Organization (ACO). There were basic questions to answer: What is Hawai'i Health Partners? What is the role of the provider? Since then we've laid the groundwork for the future of health care in Hawai'i and as a physician-led ACO delivering on value-based care, clinical leadership, and care coordination.

Over the ensuing four years, the Annual Membership Meeting has become the platform that brings together providers across all specialties to exchange ideas, put them into action, and connect with like-minded colleagues. Building on the success of previous meetings, the 2019 Meeting is the ideal forum for us to continue our good work innovating and expanding the transformation of health care in Hawai'i.

This year's program will be both exciting and ground-breaking in its format of engagement, networking activities, and physician-led sessions with wide-ranging multidisciplinary speakers associated with clinical and practical tracks.

We are confident you will find the meeting valuable and rewarding. We ask that you bring your innovative and agile mindset and be ready to engage with hundreds of your like-minded peers in meaningful information sharing.

Thank you for attending!

Gerard Livaudais, MD, MPH, FACP • *Vice President*

Andy Lee, MD • *Medical Director*

Melanie Nordgran, MBA • *Director of Operations*

Meeting In Numbers

29

SPEAKERS

4

NETWORKING OPPORTUNITIES

8

SESSIONS

7

WORKGROUPS

HHP AT A GLANCE

HHP In Numbers

2014

LAUNCHED

1

HAWAII'S
1ST ACO

934

MEMBERS

85

SPECIALTIES

154

PRIMARY CARE
SPECIALISTS

5

SUPPORT
SERVICES

130,000

PATIENT
LIVES

SCHEDULE

AT A GLANCE

Hawai'i Health Partners reserves the right to change, modify, add, or remove portions of the program at any time.

8:30 AM to 9:15 AM

Registration and Networking Breakfast
Coral Lounge

9:15 AM to 9:35 AM

Opening Ceremonies
Ray Vara | President & CEO,
Hawai'i Pacific Health
Gerard Livaudais, MD | Vice President,
Hawai'i Health Partners
Coral Ballroom 1-3

9:35 AM to 9:50 AM

State of the ACO
Gerard Livaudais, MD
Andy Lee, MD | Medical Director,
Hawai'i Health Partners
Coral Ballroom 1-3

9:50 AM to 10:20 AM

Strength of Hospital Partnerships in Enhancing Patient Care Options (CME/MOC)
Martha Smith | Chief Executive Officer,
Kapi'olani Medical Center for Women & Children
Art Gladstone | Chief Executive Officer, Pali Momi
Medical Center and Straub Medical Center
Jen Chahanovich | President & Chief Executive Officer,
Wilcox Medical Center and Chief Executive Officer,
Kaua'i Medical Clinic
Steve Robertson | Executive Vice President
& Chief Information Officer, Hawai'i Pacific Health
Coral Ballroom 1-3

10:20 AM to 11:05 AM

Speed-Networking
Coral Ballroom 1-3

11:05 AM to 11:25 AM

Break

SCHEDULE

AT A GLANCE

Hawai'i Health Partners reserves the right to change, modify, add, or remove portions of the program at any time.

11:25 AM to 11:55 AM

Joy in Practice and Redefining Patient Care (CME/MOC)

Primary Care

Jonathan Kim, MD
Sandra Noon, DO

Oncology

Craig Boddy, MD
Ian Okazaki, MD

Gastroenterology

Aaron Small, MD
Ike Tanabe, MD

Coral Ballroom 1-3

11:55 AM to 12:25 PM

Improving Patient Access and Specialty Care with eConsults (CME/MOC)

Beau Nakamoto, MD
Bennett Loui, MD
Jeremy Lum, MD
Marti Taba, MD
Siuling Kwan, MD
Todd Miller, MD

Coral Ballroom 1-3

12:25 PM to 1:25 PM

Lunch & Roundtable Discussions

Coral Ballroom 4-5

1:25 PM to 2:05 PM

NIA and Prior Authorization – A New Approach to Appropriate Imaging (CME/MOC)

Gerard Livaudais, MD
Andy Lee, MD

Coral Ballroom 1-3

SCHEDULE

AT A GLANCE

Hawai'i Health Partners reserves the right to change, modify, add, or remove portions of the program at any time.

12:25 PM to 1:25 PM

**Breakout Session for
Pediatrics: Subspecialty
Access and Referral Processes**

Ken Nakamura, MD
Keith Matsumoto, MD
South Pacific Rooms 1 & 2

1:25 PM to 2:05 PM

**Breakout Session for Obstetrics &
Gynecology: How HHP Can Make Your Life
Better as an OB/GYN**

Carol Fujiyoshi, MD
Dena Towner, MD
Richard McCartin, MD
Ronnie Texeira, MD
South Pacific Rooms 3 & 4

2:05 PM to 2:35 PM

Clinical Workgroup Presentations (CME/MOC)

Atrial Fibrillation Accelerated Ambulatory Pathway

Spencer Smith, MD
Jonathan Rosenthal, MD

Renal Stone Accelerated Ambulatory Pathway

Franklin Lee, MD

Respiratory Virus Panel Test Utilization

Travis Hong, MD

Coral Ballroom 1-3

2:35 PM to 2:55 PM

Q&A

Ray Vara
Gerard Livaudais, MD
Andy Lee, MD

Coral Ballroom 1-3

2:55 PM to 3:00 PM

Closing Ceremonies

3:00 PM to 4:00 PM

Networking & Afternoon Reception

Coral Lounge

SESSION DESCRIPTIONS

State of the ACO **9:35 am to 9:50 am** **Coral Ballroom 1-3**

Awareness of ACO highlights, milestones and upcoming initiatives is critical to understanding who you are as a member, what's important to us, and what we are achieving together. Learn how we're changing health care, and how it relates to your practice.

Strength of Hospital Partnerships in Enhancing Patient Care Options **9:50 am to 10:20 am** **Coral Ballroom 1-3**

An overview of the major initiatives between the hospital system and HHP physicians to improve patient and population health outcomes. HPH leaders in operations and technology leaders share their perspectives on the physicians/hospital system and how they're driving change.

Joy in Practice and Redefining Patient Care **11:25 am to 11:55 am** **Coral Ballroom 1-3**

Achieve an improved work life by identifying ways to adapt your care delivery and workflow. Providers from three different specialties share their successes and simple strategies that busy providers can successfully employ.

Improving Patient Access and Specialty Care with eConsults **11:55 am to 12:25 pm** **Coral Ballroom 1-3**

The curbside consult comes of age with eConsults. Learn how early adopters are improving "right patient, right place, right provider" care with timely, documented, coordinated care.

Pediatrics Breakout Session: Subspecialty Access and Referral Processes

12:25 pm to 1:25 pm
South Pacific Rooms 1 & 2

Optimize subspecialty access and improve the referral process for primary care pediatricians to pediatric specialists.

Obstetrics & Gynecology Breakout Session: How HHP Membership Can Make Your Life Better as an OB/GYN **1:25 pm to 2:05 pm** **South Pacific Rooms 3 & 4**

Obstetrics & Gynecology deliver a healthy Hawai'i. Explore how being a member of HHP network of providers helps you to do this effectively and efficiently.





NIA and Prior Authorization – A New Approach to Appropriate Imaging **1:25 pm to 2:05 pm** **Coral Ballroom 1-3**

Learn how a new software, DecisionPoint, will give providers access to clinical decision support and enable you to responsibly manage appropriateness within your regular provider workflow.

Clinical Workgroup Presentations **2:05 pm to 2:35 pm** **Coral Ballroom 1-3**

Your colleagues present and advocate where and how to improve care within your practice and health system. Study three different examples from providers who have designed and implemented initiatives to improve care for their patients.

SESSION OBJECTIVES

SESSION	DESCRIPTION	CME/MOC
Strength of Hospital Partnerships in Enhancing Patient Care Options	<ul style="list-style-type: none"> • Provide urgent care options to patients and expectations of care rendered in those settings. • Identify 2 procedures currently able to be performed in the ASC. • Coordinate care with oncology's care plans to help avoid unnecessary ICU and ED usage. • Give two examples of how ambient computing will affect patient care. 	 0.25 credit hours
Joy in Practice and Redefining Patient Care	<ul style="list-style-type: none"> • Integrate clinical workflows into successful pre paid care management. • Describe how being in the same network can improve outcomes, provider collegiality and sustainability. • Explain the benefits of care navigators and how to access them. 	 0.25 credit hours
Improving Patient Access and Specialty Care with eConsults	<ul style="list-style-type: none"> • Name 3 advantages of using network providers to integrate care. • List 3 benefits of eConsults. • Initiate an eConsult. 	 0.25 credit hours
NIA and Prior Authorization - A New Approach to Appropriate Imaging	<ul style="list-style-type: none"> • Use the new process for ordering diagnostic imaging (DI) studies. • Find and use appropriateness criteria resources for ordering high intensity diagnostic imaging studies. • Appraise individual and group performance in appropriate ordering of DI studies. 	 0.25 credit hours
Clinical Workgroup Presentations	<ul style="list-style-type: none"> • Name and classify (underuse, overuse, misuse) examples of physician-led initiatives to improve population health outcomes. • Explain how provider engagement in workgroups reduces unnecessary variation of care. 	 0.25 credit hours

IMPORTANT REMINDERS



Download the Social Scavenger App

A mobile based scavenger hunt designed specifically for the HHP Annual Membership Meeting, earn points by completing unique challenges.

- Accumulate points and win prizes!
- Real-time leaderboard. Where do you rank? Compete with your colleagues.
- Share your favorite moments, post messages, and watch the competition unfold via live stream.

How to Download:

Follow these simple steps to install the Social Scavenger app on your device:

1. Visit the App Store for IOS/Apple devices or Google Play for Android devices to search for the App.
2. Search for 'Social Scavenger' and download.
3. Sign-up with any email address
[Do not use an HPH email address]
4. Enter the Game Code at the prompt.
[Game code will be given on the day of the meeting at the registration desk]

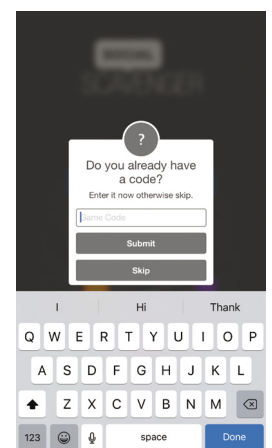
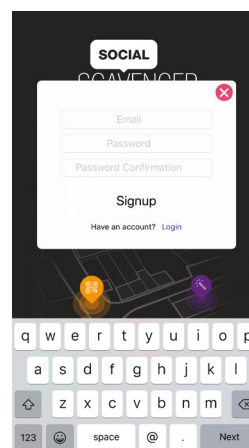
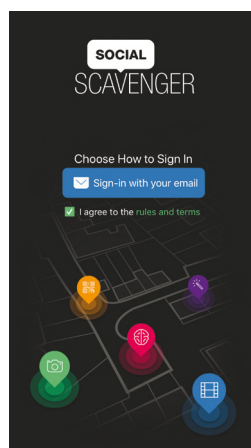
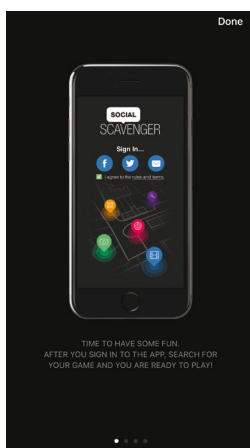
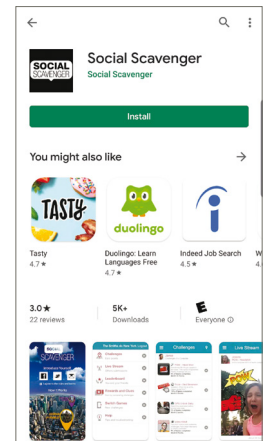
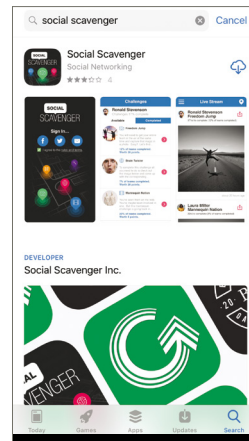

Questions?

Visit the registration table in the Coral Lounge.

- Make sure you check in at the registration table to earn your HHP Shared Savings Program (SSP) point.
- Last minute cancellation due to clinical duties?

Email Info@hawaiihealthpartners.org for the potential to still earn credit.

IMPORTANT REMINDERS



Visit the Annual Meeting Microsite

Access all available meeting materials from one place.

- Access the Welcome Packet - event schedule, session info, speaker bios, maps, and more.
- Download available presentations and handouts provided by speakers
- View the list of conference attendees

Follow these simple steps to access meeting materials:

1. Visit www.hawaiihealthpartners.org/for-providers/physician-login

2. **Login: hhpprovider**

Password: hhp2019



Connect to Wi-Fi

HHP is pleased to provide free wireless internet service throughout the day for all attendees.

Network: Hilton_Meetings

Password: hhpwifi19



Media Release

By attending the HHP Annual Membership Meeting, attendees grant permission to HPH/HHP and its agents to utilize the attendees' image or likeness in an effort to promote HPH/HHP. Attendees waive any right to inspect or approve the finished product or products and the advertising copy or other matter that may be used in connection therewith or the use to which it may be applied.

SPEAKERS & PRESENTERS

OPENING CEREMONIES



RAYMOND P. VARA
PRESIDENT & CEO, HAWAI'I PACIFIC HEALTH

His responsibilities include executive oversight of Straub Medical Center, Kapi'olani Medical Center for Women & Children, Pali Momi Medical Center and Wilcox Health on Kaua'i. Prior to joining Hawai'i Pacific Health in 2002, Mr. Vara was the Chief Executive Officer for Los Alamos Medical Center, a member of Banner Health System, in Los Alamos, New Mexico. Previous to that, Mr. Vara was the center's Chief Financial Officer. From 1988-98, Mr. Vara served as a U.S. Army Officer with various assignments including Assistant Administrator and Chief Financial Officer for Bassett Army Community Hospital in Fairbanks, Alaska, and the Deputy Chief Financial Officer for Madigan Army Medical Center in Tacoma, Washington. Mr. Vara additionally served with the 9th Infantry Regiment, FT Lewis, WA and Tripler Army Medical Center here in Honolulu. Mr. Vara graduated from Hawaii Pacific University in 1993 where he earned his Bachelor of Science in Business Administration. He received his Master of Business Administration at the University of Alaska at Fairbanks. He is a member of the American College of Healthcare Executives and serves on several local and national boards to include: Director, Bank of Hawaii Corporation; Director, Island Holdings, Inc.; Director, Island Insurance Co., Ltd.; Chairman-Elect, American Heart Association (National); Trustee, Hawaii Pacific University; Trustee, Mid-Pacific Institute; and Trustee, Blood Bank of Hawaii. He and his wife, Tiffany, have five children. Mr. Vara has been a director of Hawai'i Pacific Health since 2013.

STATE OF THE ACO



GERARD LIVAUDAIS, MD, MPH, FACP
VICE PRESIDENT, HAWAI'I HEALTH PARTNERS

Dr. Livaudais served as chief resident and then co-director of the residency program before taking on roles as vice president of Medical Affairs at Louisiana Health Care Review (a HCFA Peer Review and Quality Improvement Organization), as well as medical director, board member and other leadership positions at multi-specialty groups (Medford Clinic, Hawaii Permanente Medical Group). Before joining Hawai'i Pacific Health, he was the chief medical officer for Quantros, a patient safety and clinical quality software company. He is a member of the HHP Board of Managers, the American College of Healthcare Executives and a Fellow of the American College of Physicians. A board certified internist, he has more than 20 years of experience as an internist, medical manager, medical software professional, clinical leader and health care executive. He received his Medical Degree from Tulane University School of Medicine, where he completed a combined internal medicine/pediatric internship and internal medicine residency.

SPEAKERS & PRESENTERS



ANDY LEE, MD
MEDICAL DIRECTOR, HAWAI'I HEALTH PARTNERS

Dr. Lee received his undergraduate degree at the University of California, Irvine, and earned his Medical Degree at the University of Hawai'i at Mānoa John A. Burns School of Medicine. He completed his emergency medicine residency at the Medical College of Pennsylvania-Hahnemann University/Allegheny General Hospital in Pittsburgh and is board certified in emergency medicine. He is the Chief of Staff at Pali Momi Medical Center and a member of their Board of Directors. He has also served as a member on the HHP Board of Managers, Department of Medicine Chair at Pali Momi Medical Center, and in numerous leadership roles beyond HHP; President of the American College of Emergency Physicians Hawai'i Chapter, Assistant Medical Director for U.S. Acute Care Solutions; board member, Regional Director and Quality Director for the Emergency Physicians Medical Group and Emergency Medicine Physicians.

STRENGTH OF HOSPITAL PARTNERSHIPS IN ENHANCING PATIENT CARE OPTIONS



MARTHA B. SMITH
CHIEF EXECUTIVE OFFICER, KAPI'OLANI MEDICAL CENTER
FOR WOMEN & CHILDREN

Martha joined Hawai'i Pacific Health in October 2004 and serves as the Chief Executive Officer for Kapi'olani Medical Center for Women & Children. Martha has worked in hospital operations and health care in Hawai'i and Florida for 25 years.

Mrs. Smith holds a Bachelor of Science degree in Respiratory Therapy from University of Central Florida, a Master of Public Health from University of Alabama-Birmingham and a Master of Business Administration from Chaminade University, Honolulu. She is a Fellow in the American College of Health care Executives (FACHE).

Martha is active on community and professional boards. She was recognized in 2016 as Hawai'i's Business Leader of the year, recognized in 2015 as a Girl Scouts Women of Distinction and in 2014 as The Healthcare Leader of the year by the Healthcare Association of Hawai'i. She is a past president of the Hawai'i Chapter of the American College of Healthcare Executives and is a member of the Children's Hospital Association Chief Executive Group. Mrs. Smith serves on the Child Family Services, Girl Scouts of Hawai'i and Surgicare boards. She is also on the Board of Regents of Chaminade University and the Chair of the Board of Kapi'olani Medical Specialists, a Physician Specialty Group of Hawai'i Pacific Health.

SPEAKERS & PRESENTERS



ART GLADSTONE, RN, FACHE

CHIEF EXECUTIVE OFFICER, PALI MOMI MEDICAL CENTER
AND STRAUB MEDICAL CENTER
SYSTEM NURSE EXECUTIVE, HAWAI'I PACIFIC HEALTH

Art Gladstone has served as Chief Executive Officer of Pali Momi Medical Center and Straub Medical Center since July 2015. He also serves as the Chief Nurse Executive for Hawai'i Pacific Health, a position he was appointed to in July 2004. In his leadership roles for Hawai'i Pacific Health, he is focused on ensuring the organization's mission to create a healthier Hawai'i by placing greater emphasis on preventive health, which contributes to a healthier population and healthier state. He began his career with Hawai'i Pacific Health in 1990 as a registered nurse at Pali Momi. He was promoted within the organization to various positions, including chief operating officer of Pali Momi in 2003, chief operating officer Art is a graduate of the University of Phoenix, where he earned a bachelor's degree in nursing and a master's degree in business administration. An active member in the community, Art serves as chairman of InVision, LLC., and is a member of the Board of Directors for Ahahui Koa Anuenue, Boys and Girls Club of Hawai'i, Healthcare Association of Hawai'i and University Health Alliance. He is also a fellow of the American College of Healthcare Executives (FACHE). He has been recognized with numerous awards, including the Pacific Business News' 40 Under 40 award and the Healthcare Association of Hawai'i's Distinguished Service Award for Acute Care.



JEN H. CHAHANOVICH

PRESIDENT AND CHIEF EXECUTIVE OFFICER, WILCOX MEDICAL CENTER
CHIEF EXECUTIVE OFFICER, KAUA'I MEDICAL CLINIC

Jen Chahanovich served as the Chief Executive Officer at Pali Momi Medical Center and Vice President of Hawai'i Pacific Health for 11 years prior to joining Wilcox Health. She holds a Bachelor of Science in Health Administration & Advanced Respiratory Therapy and a Master of Business Administration in Marketing. Jen is a fellow of the American Association of Respiratory Care and the American College of Healthcare Executives. She is active on many community and professional boards.



STEVE ROBERTSON

EXECUTIVE VICE PRESIDENT AND CHIEF INFORMATION OFFICER,
HAWAI'I PACIFIC HEALTH

Steve Robertson has overall responsibility for Hospital and Professional Billing, Registration, Charge Systems, Medical Records, IT Security, Transcription, Telecommunications, and Information Technology. Additional duties have included operationalizing Hawai'i Health Partners, the State's first Accountable Care Organization. Prior to joining Hawai'i Pacific Health in 1998, he served in multiple leadership positions supporting programs for General Electric Aerospace and the US Navy. He also served as a U.S. Navy nuclear submarine officer during the Cold War and was deployed in special operations missions in the Pacific. He is a State licensed Electrical Engineer, a qualified U.S. Navy Nuclear Engineer, a certified Healthcare CIO, and a Fellow in the American College of Healthcare Executives. Steve Robertson holds a degree in Chemistry from the University of South Florida, and post graduate degrees in Business Administration from the University of Hawai'i, and Systems Engineering from the Virginia Polytechnic Institute.

SPEAKERS & PRESENTERS

JOY IN PRACTICE AND REDEFINING PATIENT CARE



AARON SMALL, MD is a board certified gastroenterologist and internist. A graduate of the Mayo Clinic School of Medicine, he completed his internal medicine residency at the New York-Presbyterian - Weill Cornell Medical Center; and fellowship training at University of Pennsylvania in gastroenterology, and Virginia Mason Medical Center in advanced endoscopy.



CRAIG BODDY, MD is a board certified hematologist, medical oncologist, and internist. A graduate of the University of Illinois School of Medicine, he completed his internal medicine residency at the Washington University in St. Louis, and hematology/oncology fellowship training at Northwestern University where his clinical research focused on lymphoma. He joined the HPH Oncology Department in August 2018 and works at both Straub and Pali Momi Medical Centers. His subspecialty area of focus is malignant and benign hematology, specifically lymphoma, leukemia, and multiple myeloma.



IAN OKAZAKI, MD is a board certified hematologist, internist, and medical oncologist. A graduate of the University of Hawai'i at Mānoa John A. Burns School of Medicine, he completed his internal medicine residency at the West Los Angeles Medical Center, and hematology/oncology fellowship training at the University of Minnesota. His special interests include general oncology, melanoma, urologic malignancies, blood and marrow transplantation and immuno-therapy for cancer; and is a member of the University of Hawai'i Cancer Center, American Society of Clinical Oncology, and American Society of Hematology.



IKE TANABE, MD is a board certified gastroenterologist and internist. A graduate of the University of Washington School of Medicine, he completed his internal medicine residency at the University of Washington, and gastroenterology fellowship at the University of South Florida, Morsani College of Medicine; and is a member of the American Gastroenterological Association, American Society of Gastrointestinal Endoscopy, American College of Gastroenterology, American Medical Association.

SPEAKERS & PRESENTERS



JONATHAN KIM, MD is a board certified family physician with a practice in Kapolei. A graduate of the University of Hawai'i at Mānoa John A. Burns School of Medicine, he completed his residency at UPMC Mercy in Family Medicine and has been practicing for 20 years.



SANDRA NOON, DO is a board certified internist. A graduate of the Michigan State University College of Osteopathic Medicine, she completed her internal medicine residency at Michigan State University and St. Joseph Mercy Ann Arbor.

IMPROVING PATIENT ACCESS AND SPECIALTY CARE WITH ECONSULTS



BENNET LOUI, MD is a board certified internist and Chair of the Hawai'i Health Partners Nominating Committee. He is acting Chief of Internal Medicine at Straub Medical Center. A graduate of the Sidney Kimmel Medical College at Thomas Jefferson University, he completed his residency at the University of Hawai'i at Mānoa John A. Burns School of Medicine in Internal Medicine.



BEAU NAKAMOTO, MD is a board certified neurologist. He holds a Bachelor of Arts degree from Johns Hopkins University and graduated from the University of Hawai'i at Mānoa John A. Burns School of Medicine. He also holds a Master in Business Administration from Loma Linda University and Master of Science and Doctorate in Clinical Research from the University of Hawai'i at Mānoa. He completed his residency at the University of Utah and fellowship in neuro-ophthalmology at Emory University in Atlanta, Georgia. He is a certified physician executive and a Fellow in the American Association of Physician Leadership and the American College of Healthcare Executives; a director of Straub Medical Center since 2011, and director of Hawai'i Pacific Health since 2015.

SPEAKERS & PRESENTERS



MARTI TABA, MD, FAFP is board certified in family medicine. A graduate of the University of Hawai'i at Mānoa John A. Burns School of Medicine, she completed her residency at the Ohio Health Riverside Methodist Hospital in family medicine. She is a member of the HHP Board of Managers, the American Academy of Family Physicians and Hawai'i Academy of Family Physicians and won the Strode Award for outstanding clinical care and patient satisfaction.



SIULING KWAN, MD is board certified in family medicine. A graduate of the Northwestern University Feinberg School of Medicine, she completed her family medicine residency at The State University of New York at Stony Brook. Her professional interests include primary health care for all family members, minor surgical procedures, and women's health issues.



TODD MILLER, MD is a board certified urologist at Straub Medical Center and Pali Momi Medical Center. A graduate of the Georgetown University School of Medicine, Washington DC, he completed his urology residency at Tripler Army Medical Center, Honolulu, Hawai'i. He is a member of the HHP Board of Managers. His professional interests include pediatric urology, general urology care, incontinence and urological oncology.



JEREMY LUM, MD is board certified in cardiac electrophysiology and cardiovascular disease. A graduate of the University of Hawai'i at Mānoa John A. Burns School of Medicine, he completed his internal medicine residency at the University of Hawai'i and cardiology fellowship at the University of New Mexico and electrophysiology fellowship at Brown University. He is a member of the American College of Cardiology and Heart Rhythm Society.

PEDIATRICS BREAKOUT SESSION



KENNETH NAKAMURA, MD is board certified in neonatal-perinatal medicine and pediatrics, and Chief Medical Officer of Kapi'olani Medical Specialists. A graduate of the University of Hawai'i at Mānoa John A. Burns School of Medicine, he completed both his pediatric residency and neonatology fellowship at the University of Iowa Hospitals and Clinics. He is also a professor and chair of the Department of Pediatrics at the John A. Burns School of Medicine.

SPEAKERS & PRESENTERS



KEITH MATSUMOTO, MD is a board certified pediatrician and president and chair of the HHP Board of Managers. He holds a Bachelor of Arts degree in Psychology from the University of Michigan. A graduate of University of Hawai'i at Mānoa John A. Burns School of Medicine, he completed his internship and pediatric residency at the Harbor-UCLA Medical Center. Dr. Matsumoto is the past president of the American Academy of Pediatrics, Hawai'i Chapter and a member of the Board of

Trustees of HAPI. He is a clinical professor of pediatrics at the John A. Burns School of Medicine. Dr. Matsumoto was formerly a director of Kapi'olani Health, and was chair of the Kapi'olani Medical Center for Women & Children Board from 2001 to 2013, and also served on the Kapi'olani Medical Specialists Board from 2007 to 2018. Dr. Matsumoto has been a director of Hawai'i Pacific Health since 2013, and Board Chair since 2018.

OBSTETRICS & GYNECOLOGY BREAKOUT SESSION



DENA TOWNER, MD is board certified in obstetrics and gynecology, clinical genetics & genomics, and maternal & fetal medicine. She is an UHP physician at the Kapi'olani Medical Center for Women & Children. A graduate of the University of California, Irvine, School of Medicine, and she completed her obstetrics and gynecology residency at the University of California, Irvine; maternal-fetal med/genetics fellowship at the University of Southern California and Medical

Genetics fellowship at the Children's Hospital Los Angeles. She is a member of the Society of Maternal Fetal Medicine, American Institute of Ultrasound in Medicine, American Congress of Obstetrics and Gynecology, and Pacific Coast Obstetrical and Gynecological Society.



RICHARD MCCARTIN, MD is board certified in obstetrics and gynecology. He is an UHP physician at the Kapi'olani Medical Center for Women & Children and Pali Momi Medical Center. A graduate of the Saint George's University School of Medicine, he completed his residency at the Monmouth Medical Center in obstetrics and gynecology. He is an Assistant Professor in the Department of obstetrics and gynecology at the John A. Burns School of Medicine; and is a

member of the American Congress of Gynecology, American Association of Gynecologic Laparoscopists, Aha Medical Missions, and US Army Reserve.



RONNIE TEXEIRA, MD is board certified in obstetrics and gynecology. She is the Chief of obstetrics and gynecology at Straub Medical Center. Her clinic is located at the Kaneohe Family Health Center. A graduate of the University of Hawai'i at John A Burns School of Medicine, she completed her residency at the University of Hawai'i in obstetrics and gynecology. She is a member of the American Congress of Obstetricians and Gynecologist and is on the Hawai'i Section Nomination

Committee. Her professional interests include female adolescent medicine, contraceptive management and minimally invasive gynecologic surgery.

SPEAKERS & PRESENTERS



CAROL FUJIYOSHI, MD is a board certified in obstetrics and gynecology. She is the Chief of the obstetrics and gynecology clinic at the Kaua'i Medical Clinic and a board member at the Wilcox Medical Center. A graduate of the F. Edward Hébert School of Medicine at the Uniformed Services University of Health Sciences, she completed her obstetrics and gynecology residency at the Tripler Army Medical Center and obstetrics and gynecology fellowship at the American College of

Obstetricians and Gynecologists. She is a member of the American College of Obstetricians and Gynecologists and American Board of Obstetricians and Gynecologists.

CLINICAL WORKGROUP PRESENTATIONS



JONATHAN ROSENTHAL, MD is board certified in internal medicine. He is chief of the Hospitalist Group and section chief for the department of Inpatient Medicine at Wilcox Medical Center. A graduate of the UT Southwestern Medical School, he completed his internal medicine residency at the University of Washington. He is a member of the Society of Hospital Medicine and American College of Physicians.



FRANKLIN LEE, MD is board certified in urology. A graduate of Sidney Kimmel Medical College at the Thomas Jefferson University, he completed his urology residency at the University of Washington.



SPENCER SMITH, MD is board certified in emergency medicine. A graduate of Saint George's University School of Medicine, he completed his residency at the University of Mississippi Medical Center in emergency medicine.



TRAVIS HONG, MD is board certified in pediatric emergency medicine and general pediatrics. A graduate of the Keck School of Medicine of the University of Southern California, completing his pediatrics residency at the Children's Hospital Los Angeles and pediatric emergency medicine fellowship at Children's Hospital Los Angeles. He is a member of the American Academy of Pediatrics.

CME/MOC

TARGET AUDIENCE

This conference is intended for physicians.



JOINTLY ACCREDITED PROVIDER™
INTERPROFESSIONAL CONTINUING EDUCATION

CONTINUING EDUCATION

In support of improving patient care, Hawai'i Pacific Health is jointly accredited by the Accreditation Council for Continuing Medical Education (ACCME), the Accreditation Council for Pharmacy Education (ACPE), and the American Nurses Credentialing Center (ANCC), to provide continuing education for the healthcare team.

Hawai'i Pacific Health designates this live activity for a maximum of 2.5 AMA PRA Category 1 Credits™ for physicians. Physicians should only claim credit commensurate with the extent of their participation in the activity.

HOW TO CLAIM CME CREDIT/MOC POINTS

Please note that in order to receive continuing education credits and MOC points for this offering, you must:

- Be registered for this activity and sign in.
- Claim credit commensurate with the extent of your participation in the activity.
- Complete and submit the evaluation survey that will be emailed to you within one week of the offering. For MOC points, the reflective learning summary section is required.
- Your CE certificate will be

immediately available to you upon completion of your evaluation.

- Your MOC information will be submitted to the ACCME by the HPH Continuing Education department.
- Speakers may not claim credit for their own presentations.

MOC CREDIT INFO.



This activity contributes to the CME component of the American Board of Anesthesiology's redesigned Maintenance of Certification in Anesthesiology™ (MOCA®) program, known as MOCA 2.0®. Please consult the ABA website, www.theABA.org, for a list of all MOCA 2.0 requirements.



Successful completion of this CME activity, which includes participation in the evaluation component, enables the participant to earn up to 2.5 MOC part two points in the American Board of Internal Medicine's (ABIM) Maintenance of Certification (MOC) Program. Participants will earn MOC points equivalent to the amount of CME credits claimed for this activity. It is the CME activity provider's responsibility to submit participant complete information to the ACCME for the purpose of granting ABIM MOC Credit.



AMERICAN BOARD
OF OPHTHALMOLOGY
Advancing Excellence in Eye Care

Successful completion of this CME activity, which includes participation in the evaluation component, enables the

learner to satisfy the Lifelong Learning, Self-Assessment, Improvement in Medical Practice and/or Patient Safety requirements for the American Board of Ophthalmology's Maintenance of Certification program. It is the CME activity provider's responsibility to submit learner completion information to ACCME for the purpose of granting MOC credit.



Successful completion of the CME activity, which includes participation in the activity and individual assessment of and feedback to the learner, enables the learner to earn up to 2.5 MOC points in the American Board of Pediatrics (ABP) Maintenance of Certification (MOC) Program. It is the CME activity provider's responsibility to submit learner completion information to the ACCME for the purpose of granting ABP MOC credit.



This activity has been registered to offer credit in the American Board of Pathology (ABPath) Maintenance of Certification program. Successful completion of this CME activity, which includes participation in the evaluation component, enables the participant to earn up to 2.5 MOC Lifelong Learning part two points.



Please direct any questions you may have regarding your evaluation or CE certificate to the HPH Continuing Education Department at hphcontinuingeduc@hawaiipacifichealth.org.

Special Events

Networking Breakfast

8:30 am to 9:15 am
Coral Lounge

Enjoy a hearty breakfast, coffee, and network with new and old colleagues. Start the meeting off on the right foot by completing early-bird Social Scavenger challenges.

Professional Headshots

8:30 am to 1:15 pm
Coral Lounge

Your headshot is your introduction and first impression.

Update your headshot for the HPH/HHP 'Find a Physician' database.

Massages

10:00 am to 2:00 pm
Coral Lounge

Take time to relax. Visit one of eight relaxation stations for a neck and back massage. Sign-up for a time at the registration table or walk-in.

Roundtable Discussions

12:25 pm to 1:25 pm
Coral Ballroom 4-5

Lunch with a fun purpose. Open seating. Informal discussions. Keep the conversation going around the sessions you've attended. Compile and share your table's opinions via challenges in Social Scavenger.

HHP Clinical Workgroups Poster Boards

All Day • Coral Lounge

Get inspired. Showcasing the work and results of various HHP clinical workgroups and ambulatory care pathways. Stop by and learn about new physician-led initiatives and programs.

- **A Pathway for Atrial Fibrillation Presenting to the Emergency Room at Pali Momi Medical Center**
Dr. Cyrus Szeto-Wong

- **An Accelerated Ambulatory Pathway for Patients with Chest Pain Presenting to the Emergency Room at Straub Medical**
Dr. Lisa Tan

- **Advancing and Standardizing Diabetes Treatment**
Dr. Marti Taba

- **Outpatient Pulmonary Embolism Management, Dr. Samuel Evans**

- **Viscosupplementation Standardization, Dr. Kiran Vadada**

- **Addressing Social Determinants of Health in Daily Practice**
Kelsie Kodama

Photobooth

12:30 pm to 3:30 pm
Coral Lounge

A picture is worth a thousand words. Bring a new friend, bring an old friend. Stop by the photobooth and receive an instant memory of your time at the HHP 6th Annual Membership Meeting.

Speed Networking

10:20 am to 11:05 am
Coral Ballroom 1-3

Get to know who's in the HHP network. An evolution from the speed dating model of meeting a lot of people in a short amount of time. Our group speed networking format will connect you with providers across all specialties.

Afternoon Reception

3:00 pm to 4:00 pm
Coral Ballroom 1-3

Pau hana starts early. Make a last minute dash to the photobooth, or hang around and talk story. Just another great opportunity to connect and network with the new colleagues you've met and catch up with friends.

Biometric Screening

8:30 am to 12:30 pm
Coral Lounge

Still haven't completed your biometric screening?

Take the opportunity to qualify for the 2020 discounted medical premium. Convenient and easy. Complete your screening. Signup for a time at the registration table or walkin. The biometric screening deadline is September 30th.

MEETING MAP

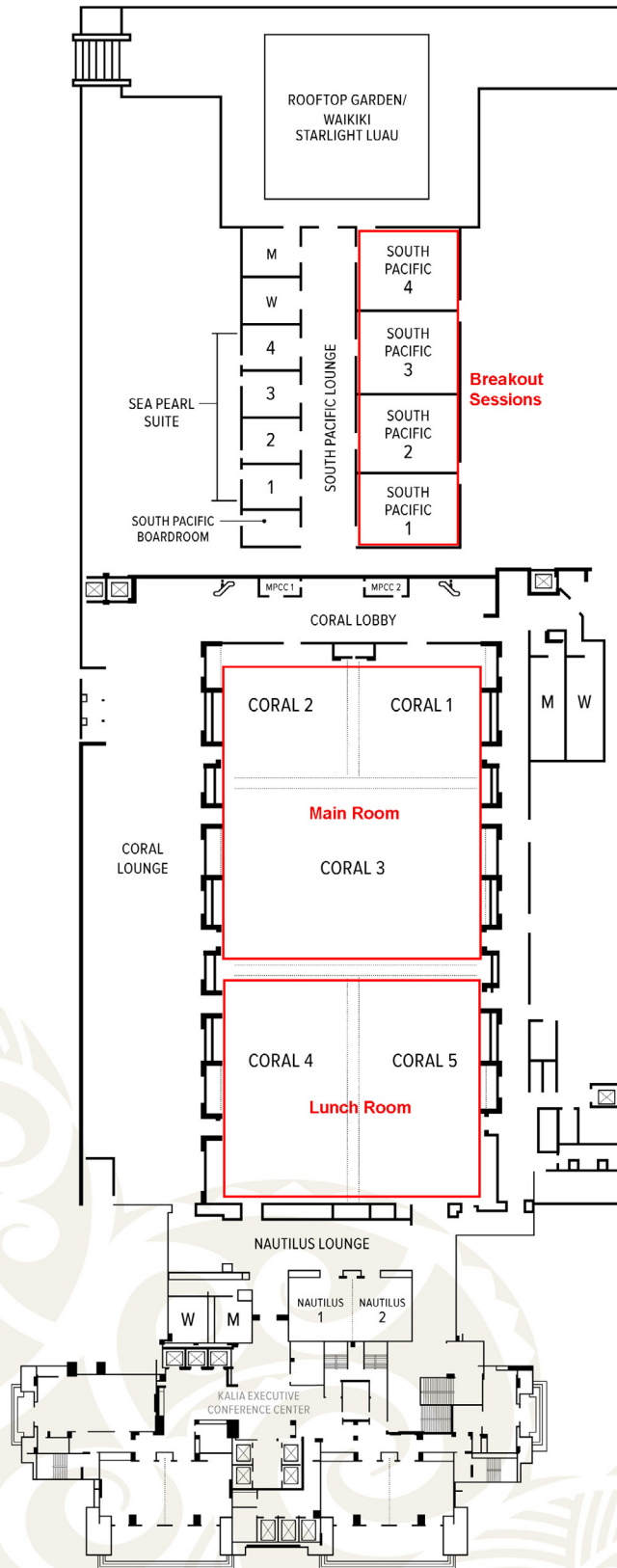

ACKNOWLEDGEMENTS



ANNUAL MEETING PHYSICIAN PLANNING COMMITTEE

Jonathan Aki, MD
Emergency Medicine

Nathan Angle, MD
Emergency Medicine

Amy Corliss, MD
Palliative Medicine

Carol Fujiyoshi, MD
Obstetrics & Gynecology

Susan Hurley, MD
Hospitalist - Family Medicine

Katsuya Iizuka, MD
Family Medicine

Keith Matsumoto, MD
Pediatrics

Richard McCartin, MD
Obstetrics & Gynecology

Kenneth Nakamura, MD
Kapi'olani Medical Specialists

Lorene Ng, MD
Pediatrics

Steve Situ, MD
Hospitalist – Internal Medicine

Ronnie Texeira, MD
Obstetrics & Gynecology

Dena Towner, MD
Maternal & Fetal Medicine

Robert Wotring II, MD
Pediatrics

HAWAI'I HEALTH PARTNERS BOARD OF MANAGERS

Officers

Keith Matsumoto, MD
Chair

Dawn Miura, MD
Secretary/Treasurer

Committee Chairs

Lovedhi Aggarwal, MD
Quality & Clinical Integration
Committee

Bennett Loui, MD
Nominating Committee

Wallace Matthews, MD
Credentialing Committee

Dawn Miura, MD
Finance Committee

Board

Andras Bratincsak, MD

Melinda Ashton, MD*

Gina French, MD

Lynn Iwamoto, MD

Clara Krebs, MD

Douglas Kwock, MD*

Wade Kyono, MD

Gerard Livaudais, MD**

Keith Matsumoto, MD

Wallace Matthews, MD*

Todd Miller, MD

Dawn Miura, MD

Sandra Noon, DO

David Cho, MD*

Huidy Shu, MD*

Marti Taba, MD

Raymond P. Vara, Jr.*

*ex officio / HPH-appointed

**ex officio, non-voting

1100 Ward Avenue, Ste. 670
Honolulu, HI 96814
Phone: 808-587-5808
Fax: 808-522-4717
E-mail: Info@hawaiihealthpartners.org

www.hawaiihealthpartners.org